



HANSA · TMP SRL

HYDRAULIC COMPONENTS
HYDROSTATIC TRANSMISSIONS
GEARBOXES - ACCESSORIES

HT 08 / B / 01B / 1002 / E / V

SLEW DRIVES 700T Series



PRODUCT FEATURES

- No 6 sizes available for output torque up to 60.000 Nm
- Up to 3 stage planetary gear units
- Outputs with integral pinion shafts supported by wide span high load capacity bearings
- Robust housing with either low or raised mounting flange
- Inputs available for various kinds of electric or hydraulic motors
- Hydraulically released failsafe parking brake, spring operated, available in combination with hydraulic motors
- Dynamic and parking brake available for all-terrain and truck mounted cranes
- Gears and bearings rated for heavy duty applications
- Oil bath lubrication
- Available with hydraulic motors complete with pressure relief and anticavitation valves

SLEW DRIVE 700T Series

Technical Informations

Type	Max. torque		Ratios 1:	Max. input speed min -1	Hydraulic motor drive (1)	Braking torque Nm	Min. opening pressure bar	Weight Kg	Design
	Excavator Nm	Crane Nm							
700 T1 F	1000	1200	3.48 - 7.2	500	LS	50 - 400	10 - 30	22	A
701 T1 F	1800	2400	3.48 - 7.2	500	LS	50 - 400	10 - 30	27	A
703 T2 F	2500	3500	12 - 44	3000	HS	50 - 400	10 - 30	45	A
705 T2 F	5000	6500	12 - 44	3000	HS	50 - 400	10 - 30	55	A
705 T2 L	5000	6500	12 - 44	3000	HS	50 - 400	10 - 30	80	B
706 T2 N	7500	10000	15 - 46	3000	HS	400 - 1000	20 - 30	95	B
707 T2 N	9000	15000	17 - 47	3000	HS	400 - 1000	20 - 30	140	B
709 T2 N	12000	20000	17 - 47	3000	HS	400 - 1000	20 - 30	165	B
711 T2 C	20000	35000	14 - 39	3000	HS	400 - 1000	20 - 30	300	B
713 T3 N	40000	55000	50 - 300	3000	HS	400 - 1000	20 - 30	500	B
715 T3 N	70000	80000	57 - 250	3000	HS	400 - 1000	20 - 30	650	B
756 T2 F	8000		28	3000	HS	200 - 300	8 - 15	90	C
757 T2 F	10000		25 - 34	3000	HS	300 - 500	8 - 15	120	C
759 T2 F	12500		28 - 32	3000	HS	400 - 700	8 - 15	150	C
711 T2 F	20000		14 - 39	3000	HS	400 - 1000	20 - 30	160	C

(1) LS = Low speed motor, HS = High speed motor

Dimensions

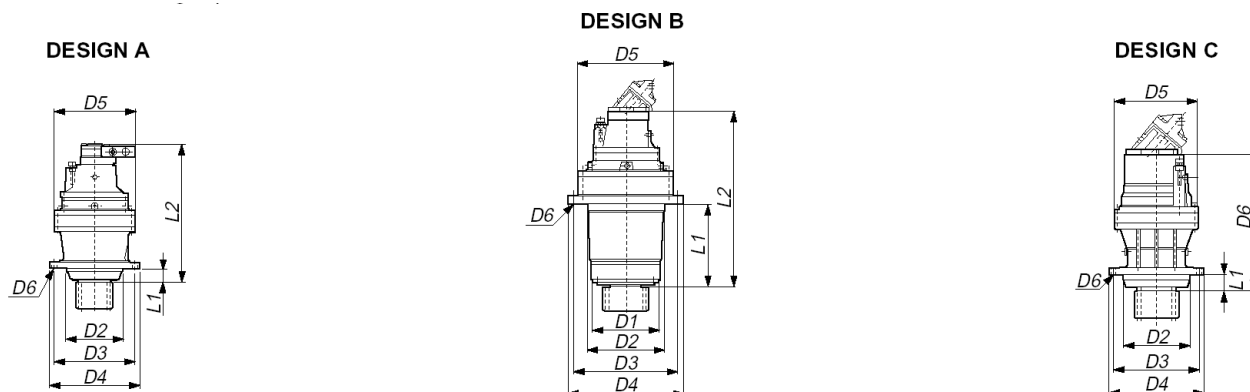

Type	Dimensions							
	D1	D2	D3	D4	D5	D6	L1	L2
700 T1 F		150	195	220	186	ø 12,5 n° 10	31	300
701 T1 F		150	195	220	186	ø 12,5 n° 10	31	325
703 T2 F		175	245	272	245	ø 18 n° 10	41	410
705 T2 F		175	245	272	245	ø 18 n° 10	41	440
705 T2 L	180	195	245	290	245	ø 13 n° 12	171	470
706 T2 N	200	250	325	360	292	ø 17 n° 10	225	560
707 T2 N	230	280	314	348	345	ø 17 n° 12	295	670
709 T2 N	250	280	380	420	345	ø 17 n° 12	295	720
711 T2 C	300	425	460	500	428	ø 22 n° 12	345	735
713 T3 N	340	400	510	560	445	ø 22 n° 24	420	1030
715 T3 N	370	470	600	640	542	ø 22 n° 24	465	1250
756 T2 F		230	335	365	300	ø 17 n° 14	55	380
757 T2 F		240	335	365	300	ø 17 n° 14	60	500
759 T2 F		280	385	420	345	ø 22 n° 14	60	540
711 T2 F		320	500	560	425	ø 22 n° 18	70	750

For further information please ask for cat. HT 08/B/01B/89

All information are given without engagement.

Hansa - TMP cannot accept responsibility for possible error in catalogues, brochures or other printed material.

Hansa - TMP reserves the right to modify its products without notice.

As HANSA-TMP has a very extensive range of products and some products have a variety of applications, the information supplied may often only apply to specific situations. If the catalogue does not supply all the information required, please contact HANSA-TMP.

In order to provide a comprehensive reply to queries we may require specific data regarding the proposed application.

Whilst every reasonable endeavour has been made to ensure accuracy this publication cannot be considered to represent part of any contract, whether expressed or implied.

HANSA-TMP reserves the right to amend specifications at their discretion.



Dutch Hydraulic Consultants BV	Tel. : +31-(0)6-83695868
Achterweg ZZ 8	Mail : info@dhc-hydraulic.nl
3216 AB Abbenbroek	Web : www.dhc-hydraulic.nl
Nederland	