



TRUCK MIXER DRIVES 500 Series



PRODUCT FEATURES

- Suitable for truck mixers in a range from 1 to 12 cubic meters.
- Torque rating from 3000 Nm to 75000 Nm.
- 2 or 3-stage planetary reductions.
- Main bearing allows for chassis bending during travelling.
Max tilting angle, in all directions is 4.5° or 6°, depending on model.
- High axial and radial load capacity.
- Suitable for both low speed and high speed hydraulic motors.
- Larger mixer drives can be provided with:
 - Water pump P.T.O.,
 - Speed sensor.

TRUCK MIXER DRIVE 500 Series

Technical Informations

Type	Max. torque Nm	Ratios 1:	Hydraulic motor drive (1)	Max. input speed min -1	Drum capacity (2)	Weight Kg	Oil quantity l	Design	Water pump P.T.O.	Speed sensor
501	3000	17-23-29	LS	550	0,5 - 1	45	1,5	A	-	-
564	12000	78-161	HS	2500	2 - 3	85	2	A	-	-
565	12000	22	LS	550	2 - 3	70	1,5	A	-	-
567	20000	76-90-115-128	HS	2500	4 - 5	140	3	A	-	-
568	20000	18-21-27	LS	550	4 - 5	130	2,5	A	-	-
575	50000	100	HS	3000	6 - 8	250	7	B	•	•
577	60000	131	HS	3000	8 - 10	290	8,5	B	•	•
580	75000	130-147	HS	3000	10 - 12	320	10	B	•	•

(1) LS = Low speed motor, HS = High speed motor

(2) General indication, application capacity depend on concrete slump

- = Not available

• = Available

Dimensions

DESIGN A

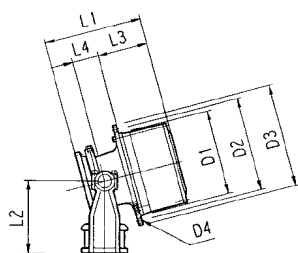

DESIGN B

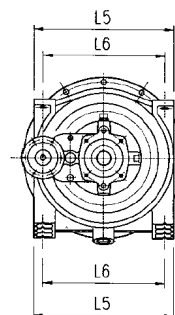
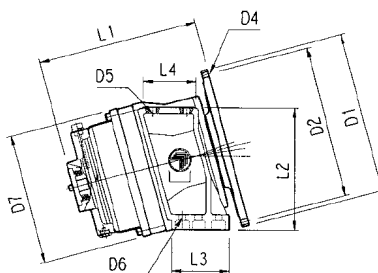

Type	Dimensions												
	D1	D2	D3	D4	D5	D6	D7	L1	L2	L3	L4	L5	L6
501	200	222	245	13 N° 4				270	195	138	89		
564	280	310	340	17 N° 10				365	240	165	85		
565	280	310	340	17 N° 10				290	240	165	85		
567	358	390	430	17 N° 18				435	300	210	110		
568	358	390	430	17 N° 18				360	300	210	110		
575	530	500		17 N° 24	22 N° 4	22 N° 6	435	450	400	188	170	460	400
577	530	500		17 N° 24	22 N° 4	22 N° 6	435	450	400	188	170	460	400
580	530	500		17 N° 24	22 N° 4	22 N° 6	435	525	400	188	170	460	400

For further information please ask for cat. HT 06/B/000

All information are given without engagement.

Hansa - TMP cannot accept responsibility for possible error in catalogues, brochures or other printed material.

Hansa - TMP reserves the right to modify its products without notice.

As HANSA-TMP has a very extensive range of products and some products have a variety of applications, the information supplied may often only apply to specific situations.

If the catalogue does not supply all the information required, please contact HANSA-TMP.

In order to provide a comprehensive reply to queries we may require specific data regarding the proposed application.

Whilst every reasonable endeavour has been made to ensure accuracy, this publication cannot be considered to represent part of any contract, whether expressed or implied.

HANSA-TMP reserves the right to amend specifications at their discretion.



Dutch Hydraulic Consultants	Tel.	+31-(0)6-83695868
Achterweg ZZ 8	Mail	info@dhc-hydraulic.nl
3216AB Abbenbroek	Web	www.dhc-hydraulic.nl
Nederland		